

OXFORD CAMBRIDGE AND RSA EXAMINATIONS
GCSE

A914/02

HEALTH AND SOCIAL CARE
Safeguarding and Protecting
Individuals

TUESDAY 19 JUNE 2018: Afternoon

DURATION: 1 hour
plus your additional time allowance

MODIFIED ENLARGED

Candidate forename		Candidate surname	
-------------------------------	--	------------------------------	--

Centre number						Candidate number				
--------------------------	--	--	--	--	--	-----------------------------	--	--	--	--

Candidates answer on the Question Paper.

OCR SUPPLIED MATERIALS:

None

OTHER MATERIALS REQUIRED:

None

READ INSTRUCTIONS OVERLEAF



INSTRUCTIONS TO CANDIDATES

Write your name, centre number and candidate number in the boxes on the front page. Please write clearly and in capital letters.

Use black ink. Pencil may be used for graphs and diagrams only.

Read each question carefully. Make sure you know what you have to do before starting your answer.

Write your answer to each question in the space provided. If additional space is required, you should use the lined page(s) at the end of this booklet. The question number(s) must be clearly shown.

Answer ALL the questions.

INFORMATION FOR CANDIDATES

The number of marks is given in brackets [] at the end of each question or part question.

Quality of Written Communication will be assessed in questions marked with an asterisk (*).

The total number of marks for this paper is 60.

Answer ALL the questions.

- 1 Identify THREE different personal hygiene procedures a care worker should follow and give a reason for each.**

Personal hygiene procedure _____

Reason _____

Personal hygiene procedure _____

Reason _____

Personal hygiene procedure _____

Reason _____

[6]

2 (i) Identify two diseases or illnesses that must be reported in a care home.

1 _____

2 _____

[2]

(ii) Identify two conditions with the building or environment that must be reported.

1 _____

2 _____

[2]

[illegible]

4 State TWO requirements of the Health and Safety (First Aid) Regulations 1981.

1 _____

2 _____

[2]

[illegible]

- 6 Sundus has a bleeding arm wound with a large piece of glass in it.**

Complete the table below either with the first aid procedures that should be followed or with reasons why the procedure is carried out.

Some procedures and reasons have been completed for you. [6]

First aid procedure	Reason why
Ask someone to call 999 and get a first aid kit as soon as possible.	To obtain professional help as bleeding is severe.
	To expose the wound and give a clear view of it.
Do not remove the glass from the wound.	
	So that pressure can be applied on either side of the wound to try and slow down the bleeding, without pushing the glass further into the arm.
The wounded arm should be raised above the heart and supported.	
	The casualty may be feeling faint and it will be easier to elevate their arm from this position.

First aid procedure	Reason why
If the blood continues to seep through, a second dressing can be put on top of the first dressing.	

- 7 Janet does weekly shopping for John who is housebound. John always tells Janet to keep the change. Recently she has been taking more money than is required for the shopping.**

Name the type of abuse that John is a victim of.

_____ [1]

- 8 Give TWO reasons why care workers might ill-treat individuals with physical disabilities.**

1 _____

2 _____

_____ [2]

- 9 Name a piece of legislation that contributes to the safeguarding of individuals with physical disabilities.**

_____ [1]

(i) Identify TWO types of ill-treatment from the scenario.

2

(ii)* Explain the possible effects of ill-treatment on young people with learning disabilities.

[illegible]

10

11* Describe TWO ways that wider society helps to protect individuals who are vulnerable and in need of safeguarding.

[4]

12 Identify a situation when you would use a fire blanket and describe how to use it.

Situation _____

How to use a fire blanket _____

[3]

13 Complete the table with the type of fire extinguisher that would be used for each type of fire.

Choose the type of fire extinguisher from the following list:

Water

Foam

Carbon dioxide

Dry powder.

Each type of extinguisher may be used once, more than once or, not at all. [3]

Colour	Used for:	Type of extinguisher
cream marking	flammable liquids	
red marking	wood, paper, textiles	
blue marking	electrical fires	

Plan of the community area in sheltered accommodation for older people

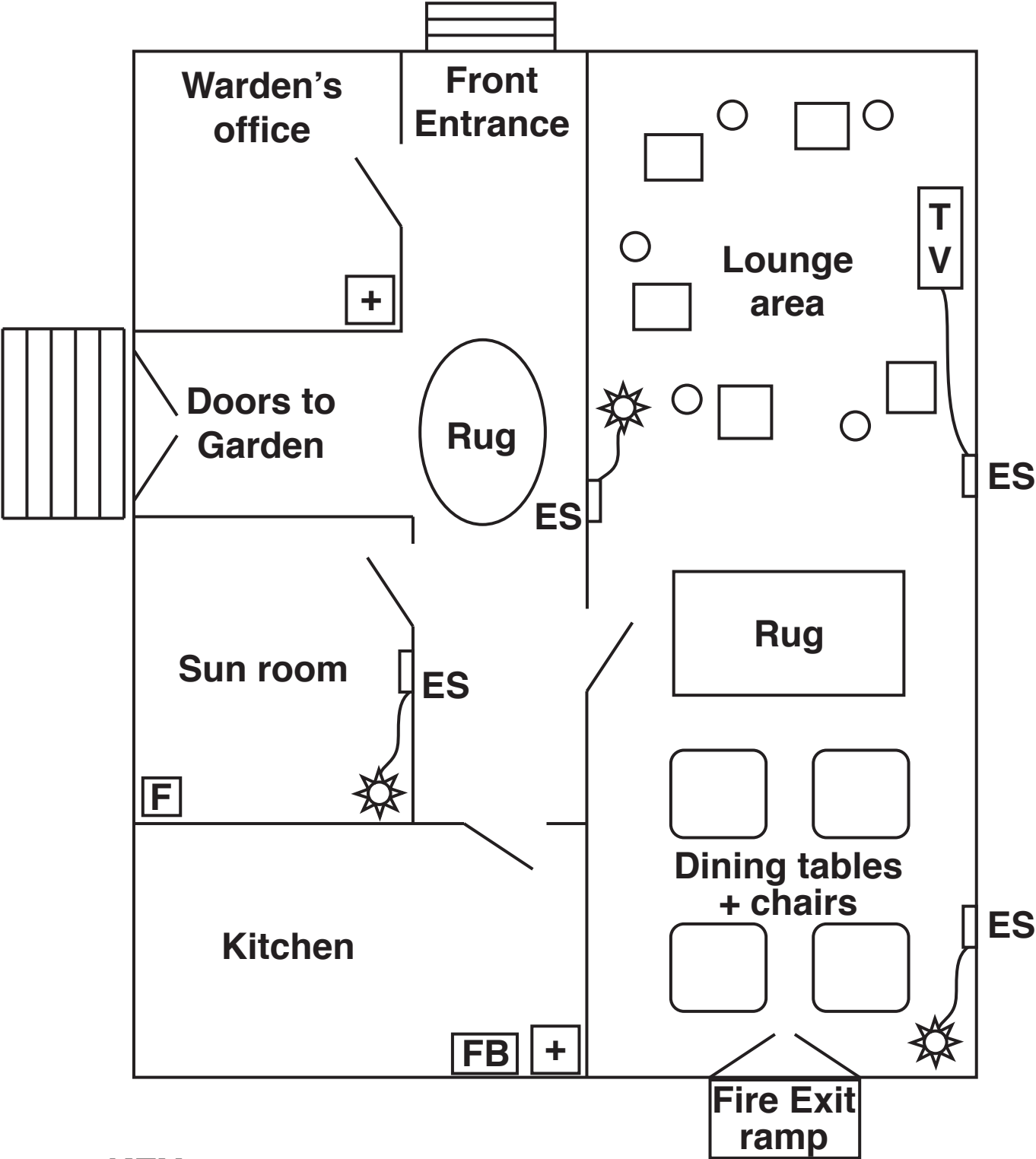

KEY:

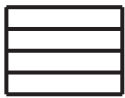

Steps



Table



Chair

ES

Electric Socket



Lamp

TV

Television



Electric Cable



First Aid Box



Fire Blanket



Fire Extinguisher



Door

14 Carry out a risk assessment for the community area in the sheltered accommodation for older people.

You need to:

look for hazards that could harm people, describe the risks

consider whether existing precautions are adequate

explain appropriate additional precautions that may be necessary. [8]

END OF QUESTION PAPER

ADDITIONAL ANSWER SPACE

If additional space is required, you should use the following lined page(s). The question number(s) must be clearly shown in the margin(s).

[illegible]



Copyright Information

OCR is committed to seeking permission to reproduce all third-party content that it uses in its assessment materials. OCR has attempted to identify and contact all copyright holders whose work is used in this paper. To avoid the issue of disclosure of answer-related information to candidates, all copyright acknowledgements are reproduced in the OCR Copyright Acknowledgements Booklet. This is produced for each series of examinations and is freely available to download from our public website (www.ocr.org.uk) after the live examination series.

If OCR has unwittingly failed to correctly acknowledge or clear any third-party content in this assessment material, OCR will be happy to correct its mistake at the earliest possible opportunity.

For queries or further information please contact the Copyright Team, First Floor, 9 Hills Road, Cambridge CB2 1GE.

OCR is part of the Cambridge Assessment Group; Cambridge Assessment is the brand name of University of Cambridge Local Examinations Syndicate (UCLES), which is itself a department of the University of Cambridge.